

## ANCHOR RIVET NUT

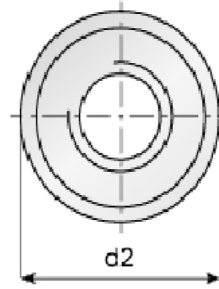
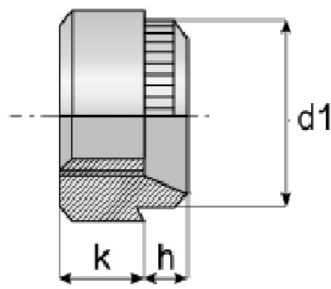

Part Code	Sheet Thickness	Thread	Nut Thickness Minimum (k)	Knurling Height (h)	Knurling Dia (d1) (-0.04/+0.06)	Body Dia (d2) (±0.10)	Hole Dia (±0.05)
MVARM32.80.9/1.0S	1	M3X0.5	2.8	1.40-1.60	4.1	5.5	4.2
MVARM32.81.4/1.6S	1.5	M3X0.5	2.8	2.00-2.20	4.1	5.5	4.2
MVARM43.20.9/1S	1	M4X0.7	3.2	1.40-1.60	5.4	7	5.5
MVARM43.2-1.4/1.6S	1.5	M4X0.7	3.2	2.00-2.20	5.4	7	5.5
MVARM43.22.0/2.25	2	M4X0.7	3.2	2.50-2.60	5.4	7	5.5
MVARM43.22.8/3.0S	3	M4X0.7	3.2	3.50-3.70	5.4	7	5.5
MVARM53.80.9/15	1	M5X0.8	3.8	1.40-1.60	6.4	8.5	6.5
MVARM53.81.4/1.6S	1.5	M5X0.8	3.8	2.00-2.20	6.4	8.5	6.5
MVARM53.81.7/1.9S	2	M5X0.8	3.8	2.50-2.60	6.4	8.5	6.5
MVARM53.82.8/3.0S	3	M5X0.8	3.8	3.50-3.70	6.4	8.5	6.5
MVARM65.10.9/1.0	1	M6X1.0	5.1	1.60-1.80	7.6	10	7.7
MVARM65.11.1/1.3S	1	M6X1.0	5.1	1.90-2.00	7.6	10	7.7
MVARM65.1.4/1.6S	1.5	M6X1.0	5.1	2.20-2.40	7.6	10	7.7
MVARM65.12.0/2.25	2	M6X1.0	5.1	2.80-2.90	7.6	10	7.7
MVARM86.51.4/1.6S	1.5	M8X1.25	6.5	2.20-2.40	9.6	12	9.7
MVARM86.52/2.25	2	M8X1.25	6.5	2.80-2.90	9.6	12	9.7

### SPECIFICATIONS & DETAILS

MVD PART CODE	MVARMXXXXXS	MVD DESCRIPTION	ANCHOR RIVET NUT STL MXXXX MM
DRAWN BY	ABHISHEK	APPROVED BY	MAGESH
DRAWING REV. NO	00	MATERIAL	STEEL - EN1A (L)
DATE		FINISH	ZINC BLUE

ALL DIMENSIONS ARE IN MM, UNLESS SPECIFIED

