

## HEX WELD NUT

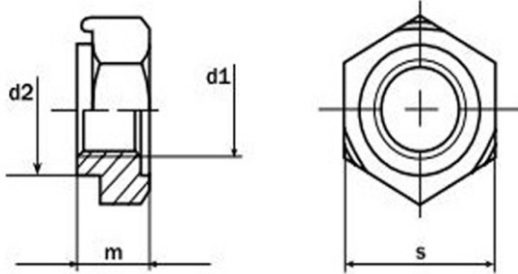

### MVD PART NO DESIGNATION

**DIN 929  
HEX WELD NUT**

MV      929      MX      S / SS      XX  
           ↓            ↓            ↓            ↓  
           DIN NO    THREAD    Material    Plating  
                           SIZE            Code            Code

d1	M3	M4	M5	M6	M8	M10	M12	M14	M16
p	0.5	0.7	0.8	1	1.25	1.5	1.75	2	2
m (h14)	3.0	3.5	4.0	5	6.50	8.0	10.00	11	13
s (h13)	7.5	9.0	10.0	11	14.00	17.0	19.00	22	24
d2 (H11)	4.5	6.0	7.0	8	10.50	12.5	14.80	17	19

*Fastening Everything*

### SPECIFICATIONS & DETAILS

MVD PART CODE	MV929MXXXX	MVD DESCRIPTION	HEX WELD NUT STL MXXXX
DRAWN BY	ABHISHEK	APPROVED BY	MAGESH
DRAWING REV. NO	00	MATERIAL	MILD STEEL
DATE		FINISH	TRIVALENT BLUE

ALL DIMENSIONS ARE IN MM, UNLESS SPECIFIED

